

AENC-TQST-LAN-DWG-0002

Norwich to Tilbury

Volume 2: Plans, Drawings and Sections

Document: 2.2 Land Plans - Section E

Final Issue A

August 2025

Planning Inspectorate Reference: EN020027

Infrastructure Planning (Applications: Prescribed Forms and Procedure) Regulations 2009 Regulation 5(2)(i)(i)-(iii)

nationalgrid

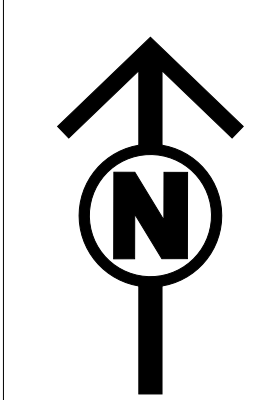

THE NATIONAL GRID (NORWICH TO TILBURY) ORDER
LAND PLANS KEY PLAN
REGULATION 5(2)(i)-(iii)
SECTION E (SHEET 1 OF 1,
BRAINTREE DISTRICT COUNCIL, COLCHESTER CITY COUNCIL AND CHELMSFORD CITY COUNCIL)

Application Document 2.2

SITE MAP

- Legend
- Local authority boundary
 - Section boundary & local authority boundary
 - Section boundary
 - Sheet Index
 - Order Limits

Notes

1. For additional detail on the plan suites, please refer to the Guide to Plans (document reference 2.0), located in the Volume 2 of the DCO application.

2. This drawing is scaled at paper size A0, therefore any prints taken at smaller sizes will affect accuracy of the measurement units and should not be scaled against.

Coordinate System: British National Grid
Sheet X Centroid Coordinate: 580835 Sheet Y Centroid Coordinate: 218950

0 250 500 1,000 1,500 2,000 2,500 Meters

BACKGROUND MAPPING INFORMATION HAS BEEN REPRODUCED FROM THE ORDNANCE SURVEY BY PERMISSION OF ORDNANCE SURVEY OF THE CONTROLLER OF HIS MAJESTY'S STATIONERY OFFICE. © CROWN COPYRIGHT AND DATABASE RIGHTS(2025) LICENCE OS100024241 AND AC000807948.

Issue	Date	Remarks	Drawn	Checked	Approved
Title:					
THE NATIONAL GRID (NORWICH TO TILBURY) ORDER LAND PLANS KEY PLAN REGULATION 5(2)(i)-(iii) SECTION E (SHEET 1 OF 1 BRAINTREE DISTRICT COUNCIL, COLCHESTER CITY COUNCIL AND CHELMSFORD CITY COUNCIL)					

nationalgrid

PINS Application Number EN020027

National Grid Drawing Reference
AENC-TQST-LAN-DWG-0002

Scale	Sheet Size	Sheet	Issue
1:16,000	A0	KEY PLAN	A

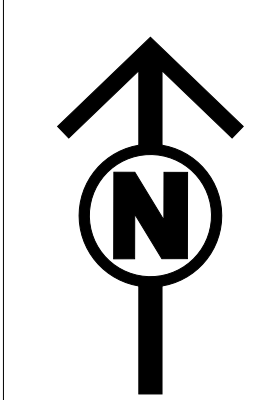

THE NATIONAL GRID (NORWICH TO TILBURY) ORDER
LAND PLANS
REGULATION 5(2)(i)-(iii)
SECTION E (SHEET 1 OF 8,
COLCHESTER CITY COUNCIL AND BRAINTREE DISTRICT COUNCIL)

Application Document 2.2

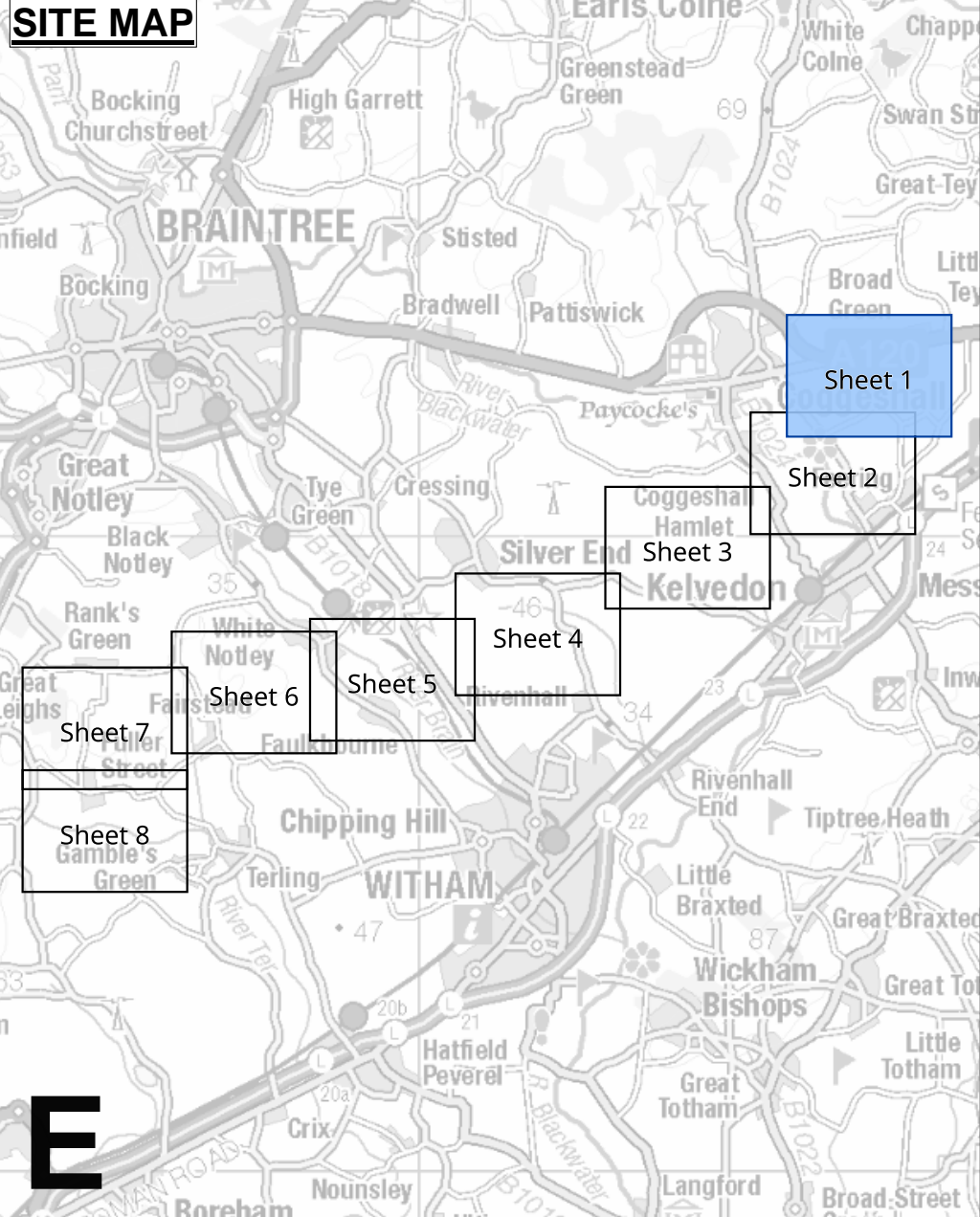

- Legend**
- Local authority boundary
 - Section boundary & local authority boundary
 - Section boundary
 - Sheet index cutlines
 - Order Limits
 - Class 1 - Compulsory acquisition of land
 - Class 2 - Compulsory acquisition of rights - Overhead line
 - Class 3 - Compulsory acquisition of rights - Underground cable system
 - Class 4 - Compulsory acquisition of rights - Overhead line and underground cable system
 - Class 5 - Compulsory acquisition of rights - Access
 - Class 6 - Compulsory acquisition of rights - Drainage
 - Class 7 - Temporary use
 - Class 8 - Land not subject to powers of acquisition nor temporary use

Notes

1. For additional detail on the plan suites, please refer to the Guide to Plans (document reference 2.0), located in the Volume 2 of the DCO application.

2. This drawing is scaled at paper size A0, therefore any prints taken at smaller sizes will affect accuracy of the measurement units and should not be scaled against.

Coordinate System: British National Grid
Sheet X Centroid Coordinate: 587091 Sheet Y Centroid Coordinate: 222537



BACKGROUND MAPPING INFORMATION HAS BEEN REPRODUCED FROM THE ORDNANCE SURVEY BY PERMISSION OF ORDNANCE SURVEY OF THE CONTROLLER OF HIS MAJESTY'S STATIONERY OFFICE. © CROWN COPYRIGHT AND DATABASE RIGHTS (2025) LICENCE OS100024241 AND AC0000807948.

A	AUG-2025	For DCO submission	BBU	KGA	CLJ
Issue	Date	Remarks	Drawn	Checked	Approved

Title:
THE NATIONAL GRID (NORWICH TO TILBURY) ORDER
LAND PLANS
REGULATION 5(2)(i)-(iii)
SECTION E (SHEET 1 OF 8
COLCHESTER CITY COUNCIL
AND BRAINTREE DISTRICT COUNCIL)

nationalgrid

PINS Application Number EN020027

National Grid Drawing Reference
AENC-TQST-LAN-DWG-0002

Scale	Sheet Size	Sheet	Issue
1:2500	A0	SHEET 1 of 8	A

FOR CONTINUATION SEE SHEET 2

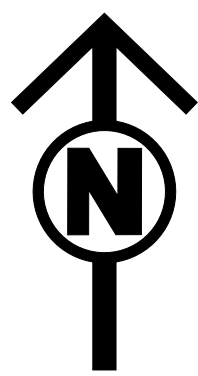

THE NATIONAL GRID (NORWICH TO TILBURY) ORDER
LAND PLANS
REGULATION 5(2)(i)(i)-(iii)
SECTION E (SHEET 2 OF 8,
BRAINTREE DISTRICT COUNCIL)

Application Document 2.2

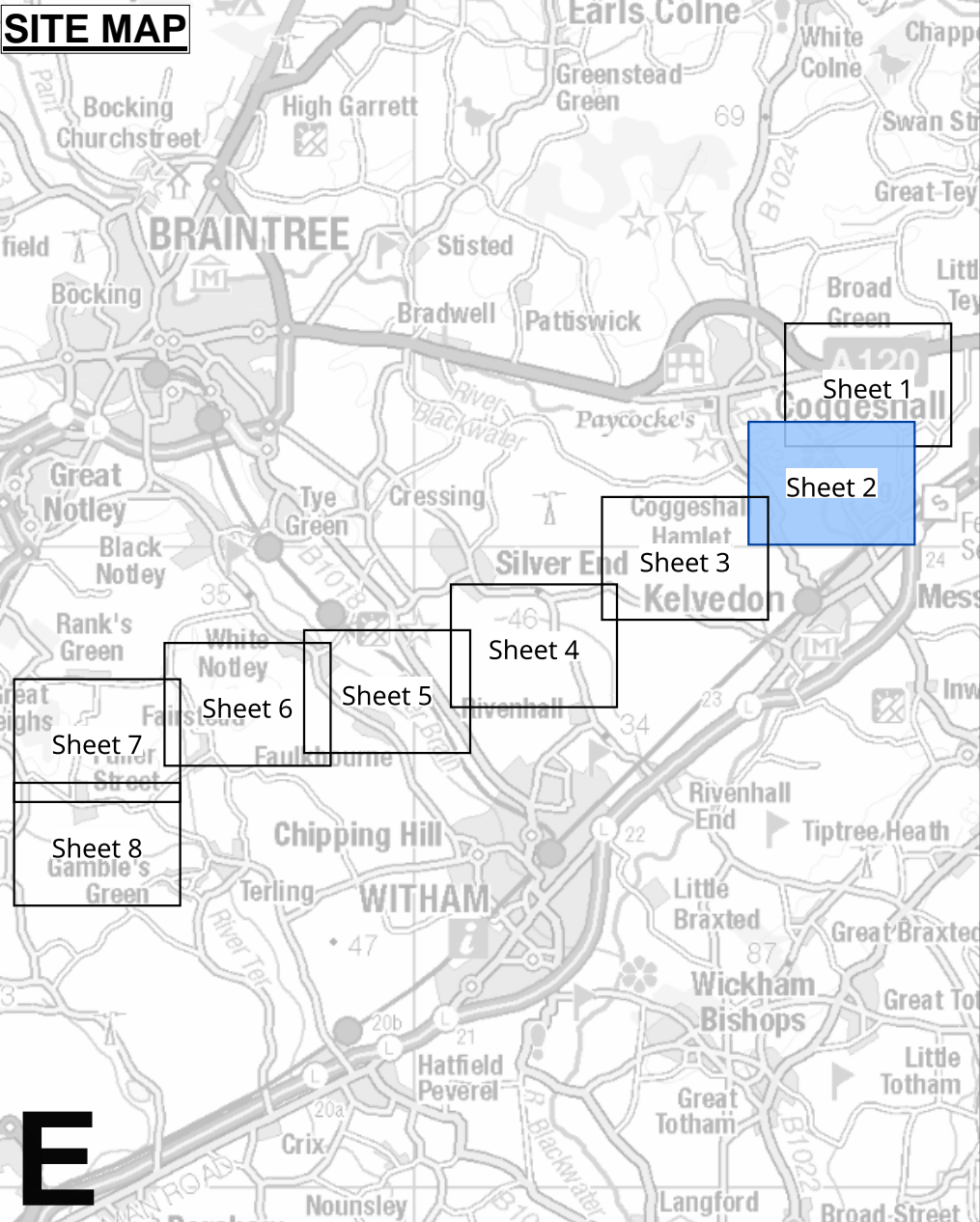

- Legend**
- Local authority boundary
 - Section boundary & local authority boundary
 - Section boundary
 - Sheet index cutlines
 - Order Limits
 - Class 1 - Compulsory acquisition of land
 - Class 2 - Compulsory acquisition of rights - Overhead line
 - Class 3 - Compulsory acquisition of rights - Underground cable system
 - Class 4 - Compulsory acquisition of rights - Overhead line and underground cable system
 - Class 5 - Compulsory acquisition of rights - Access
 - Class 6 - Compulsory acquisition of rights - Drainage
 - Class 7 - Temporary use
 - Class 8 - Land not subject to powers of acquisition nor temporary use

Notes

1. For additional detail on the plan suites, please refer to the Guide to Plans (document reference 2.0), located in the Volume 2 of the DCO application.

2. This drawing is scaled at paper size A0, therefore any prints taken at smaller sizes will affect accuracy of the measurement units and should not be scaled against.

Coordinate System: British National Grid
Sheet X Centroid Coordinate: 586519 Sheet Y Centroid Coordinate: 221000

BACKGROUND MAPPING INFORMATION HAS BEEN REPRODUCED FROM THE ORDNANCE SURVEY BY PERMISSION OF ORDNANCE SURVEY OF THE CONTROLLER OF HIS MAJESTY'S STATIONERY OFFICE. © CROWN COPYRIGHT AND DATABASE RIGHTS (2025) LICENCE OS100024241 AND AC000807948.

A	AUG-2025	For DCO submission	BBU	XXX	XXX
Issue	Date	Remarks	Drawn	Checked	Approved

Title: THE NATIONAL GRID (NORWICH TO TILBURY) ORDER
LAND PLANS
REGULATION 5(2)(i)(i)-(iii)
SECTION E (SHEET 2 OF 8,
BRAINTREE DISTRICT COUNCIL)

nationalgrid

<u>PINS Application Number</u>		EN020027	
<u>National Grid Drawing Reference</u>		AENC-TQST-LAN-DWG-0002	
<u>Scale</u>	<u>Sheet Size</u>	<u>Sheet</u>	<u>Issue</u>
1:2500	A0	SHEET 2 of 8	A

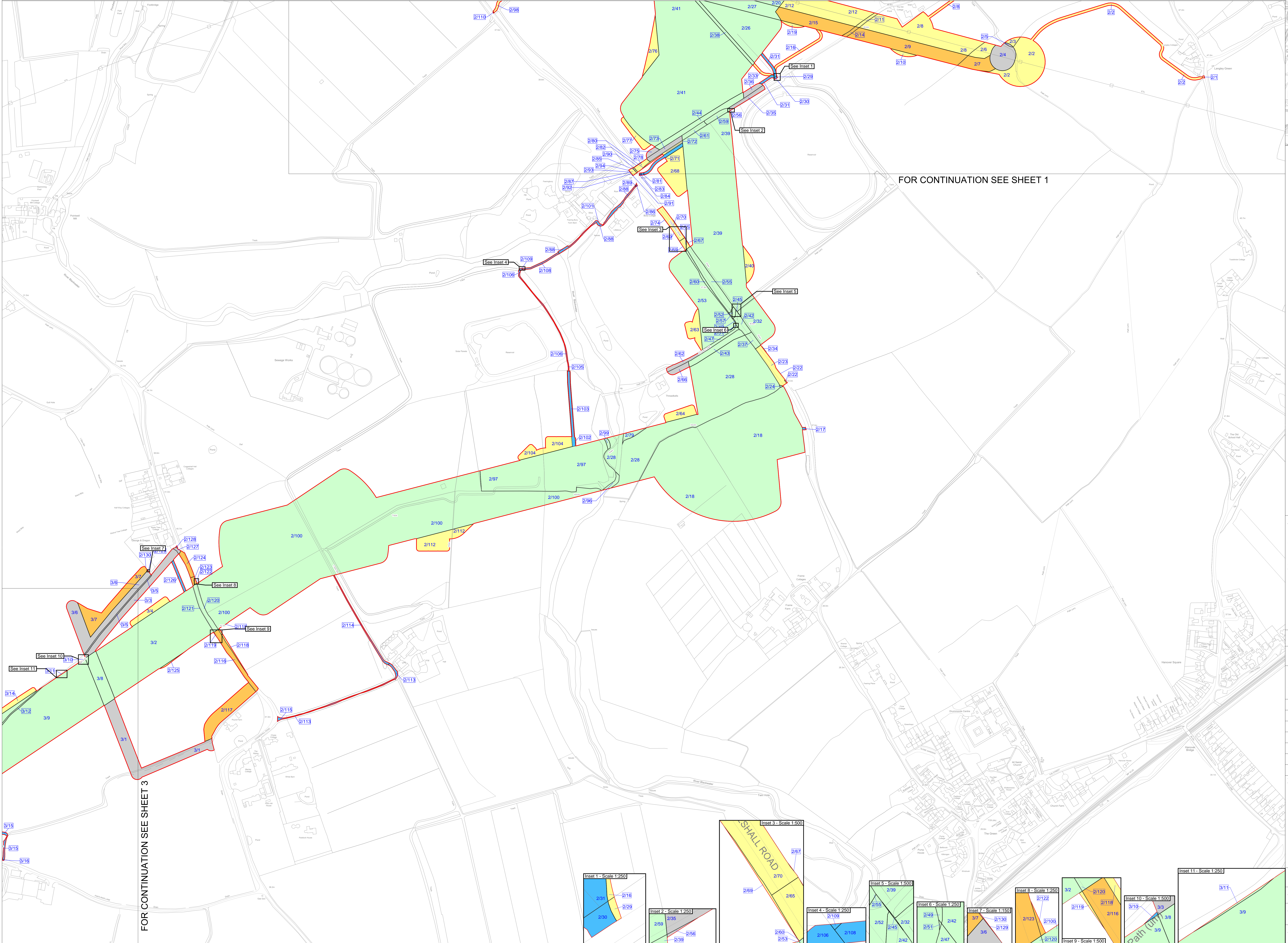

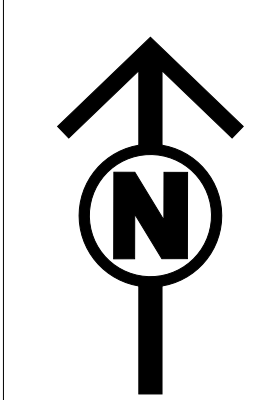

THE NATIONAL GRID (NORWICH TO TILBURY) ORDER
LAND PLANS
REGULATION 5(2)(i)-(iii)
SECTION E (SHEET 3 OF 8,
BRAINTREE DISTRICT COUNCIL)

Application Document 2.2

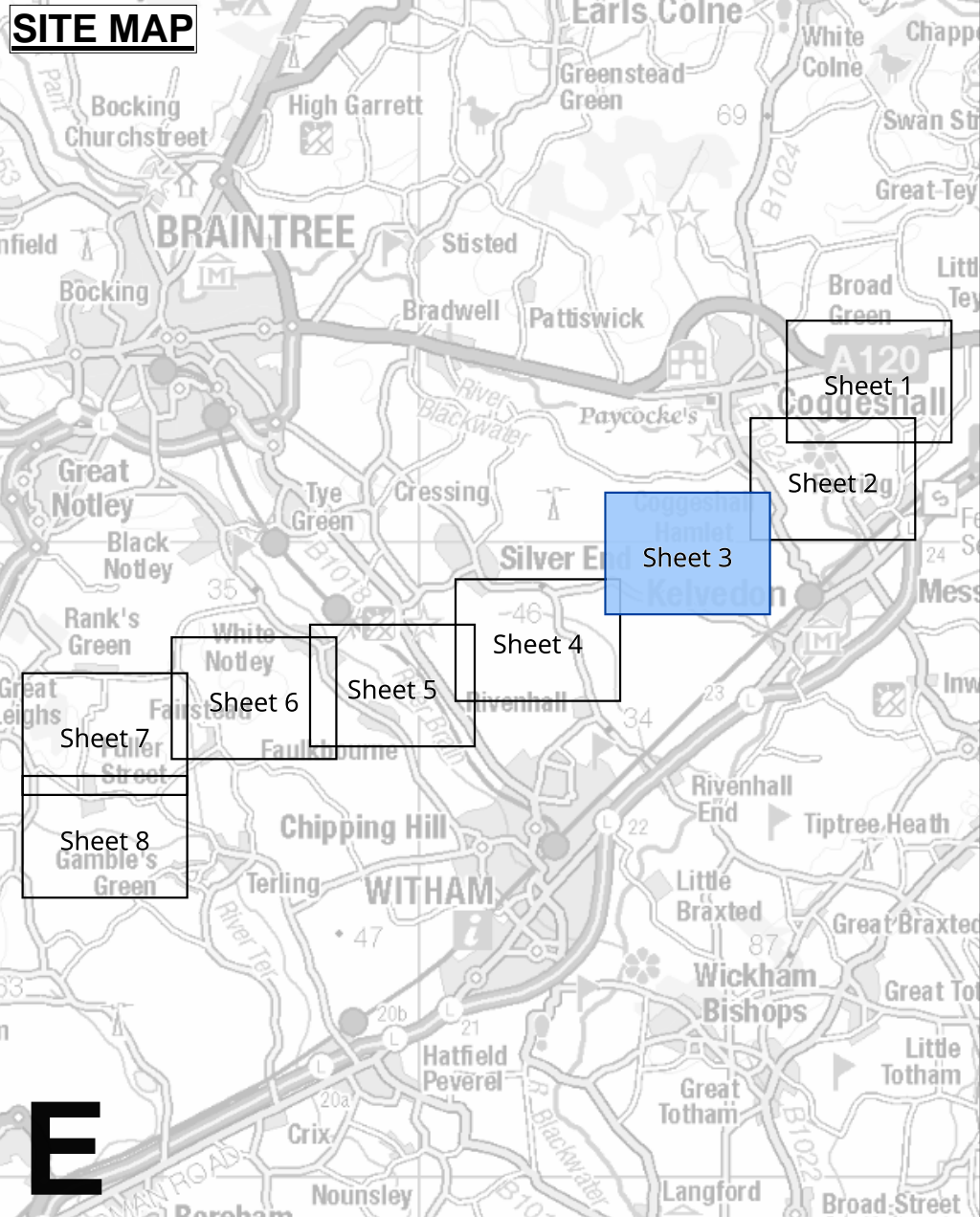

- Legend**
- Local authority boundary
 - Section boundary & local authority boundary
 - Section boundary
 - Sheet index cutlines
 - Order Limits
 - Class 1 - Compulsory acquisition of land
 - Class 2 - Compulsory acquisition of rights - Overhead line
 - Class 3 - Compulsory acquisition of rights - Underground cable system
 - Class 4 - Compulsory acquisition of rights - Overhead line and underground cable system
 - Class 5 - Compulsory acquisition of rights - Access
 - Class 6 - Compulsory acquisition of rights - Drainage
 - Class 7 - Temporary use
 - Class 8 - Land not subject to powers of acquisition nor temporary use

Notes
1. For additional detail on the plan suites, please refer to the Guide to Plans (document reference 2.0), located in the Volume 2 of the DCO application.

2. This drawing is scaled at paper size A0, therefore any prints taken at smaller sizes will affect accuracy of the measurement units and should not be scaled against.

Coordinate System: British National Grid
Sheet X Centroid Coordinate: 584231 Sheet Y Centroid Coordinate: 219826

BACKGROUND MAPPING INFORMATION HAS BEEN REPRODUCED FROM THE ORDNANCE SURVEY BY PERMISSION OF ORDNANCE SURVEY OF THE CONTROLLER OF HIS MAJESTY'S STATIONERY OFFICE. © CROWN COPYRIGHT AND DATABASE RIGHTS(2025) LICENCE OS100024241 AND AC0000807948.

A	AUG-2025	For DCO submission	BBU	CBE	CLJ
Issue	Date	Remarks	Drawn	Checked	Approved

Title:
THE NATIONAL GRID
(NORWICH TO TILBURY) ORDER
LAND PLANS
REGULATION 5(2)(i)-(iii)
SECTION E (SHEET 3 OF 8
BRAintree DISTRICT COUNCIL)

nationalgrid

PINS Application Number EN020027

National Grid Drawing Reference
AENC-TQST-LAN-DWG-0002

Scale 1:2500	Sheet Size A0	Sheet SHEET 3 of 8	Issue A
-----------------	------------------	-----------------------	------------

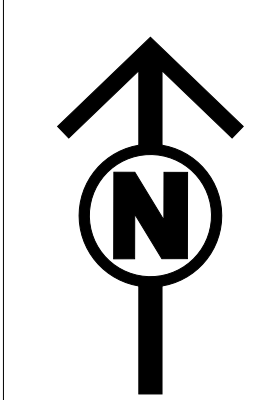

THE NATIONAL GRID (NORWICH TO TILBURY) ORDER
LAND PLANS
REGULATION 5(2)(i)-(iii)
SECTION E (SHEET 4 OF 8,
BRAINTREE DISTRICT COUNCIL)

Application Document 2.2

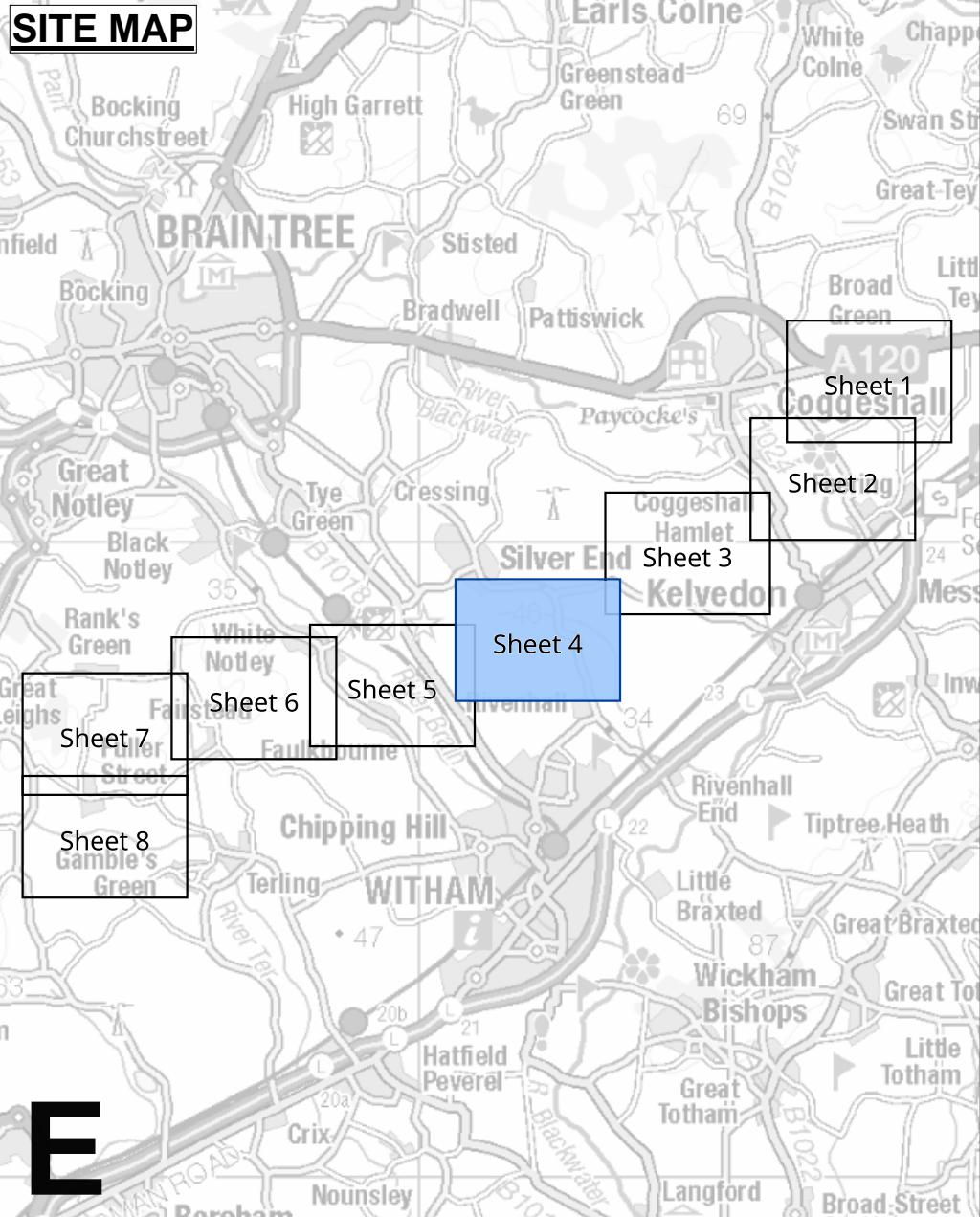

- Legend**
- Local authority boundary
 - Section boundary & local authority boundary
 - Section boundary
 - Sheet index cutlines
 - Order Limits
 - Class 1 - Compulsory acquisition of land
 - Class 2 - Compulsory acquisition of rights - Overhead line
 - Class 3 - Compulsory acquisition of rights - Underground cable system
 - Class 4 - Compulsory acquisition of rights - Overhead line and underground cable system
 - Class 5 - Compulsory acquisition of rights - Access
 - Class 6 - Compulsory acquisition of rights - Drainage
 - Class 7 - Temporary use
 - Class 8 - Land not subject to powers of acquisition nor temporary use

Notes

1. For additional detail on the plan suites, please refer to the Guide to Plans (document reference 2.0), located in the Volume 2 of the DCO application.

2. This drawing is scaled at paper size A0, therefore any prints taken at smaller sizes will affect accuracy of the measurement units and should not be scaled against.

Coordinate System: British National Grid
Sheet X Centroid Coordinate: 581870 Sheet Y Centroid Coordinate: 218461

BACKGROUND MAPPING INFORMATION HAS BEEN REPRODUCED FROM THE ORDNANCE SURVEY BY PERMISSION OF ORDNANCE SURVEY OF THE CONTROLLER OF HIS MAJESTY'S STATIONERY OFFICE. © CROWN COPYRIGHT AND DATABASE RIGHTS (2025) LICENCE OS100024241 AND AC000807948.

A	AUG-2025	For DCO submission	BBU	KGA	CLJ
Issue	Date	Remarks	Drawn	Checked	Approved

Title:
THE NATIONAL GRID
(NORWICH TO TILBURY) ORDER
LAND PLANS
REGULATION 5(2)(i)-(iii)
SECTION E (SHEET 4 OF 8
BRAINTREE DISTRICT COUNCIL)

<div><div></div><div>nationalgrid</div></div>			
<u>PINS Application Number</u>		EN020027	
<u>National Grid Drawing Reference</u>			
AENC-TQST-LAN-DWG-0002			
<u>Scale</u>	<u>Sheet Size</u>	<u>Sheet</u>	<u>Issue</u>
1:2500	A0	SHEET 4 of 8	A

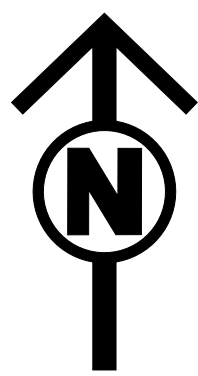

THE NATIONAL GRID (NORWICH TO TILBURY) ORDER
LAND PLANS
REGULATION 5(2)(i)(i)-(iii)
SECTION E (SHEET 5 OF 8,
BRAINTREE DISTRICT COUNCIL)

Application Document 2.2

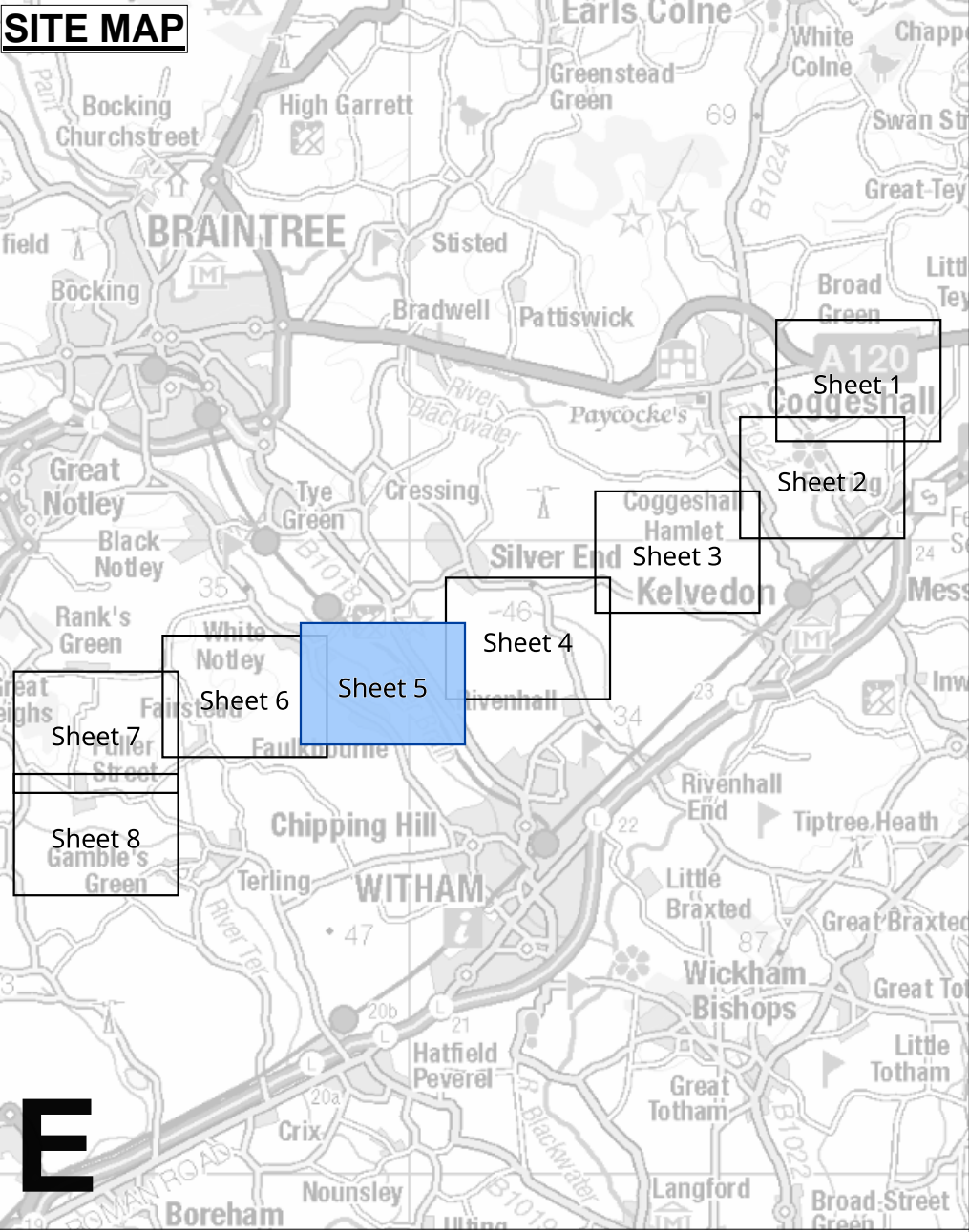

- Legend**
- Local authority boundary
 - Section boundary & local authority boundary
 - Section boundary
 - Sheet index cutlines
 - Order Limits
 - Class 1 - Compulsory acquisition of land
 - Class 2 - Compulsory acquisition of rights - Overhead line
 - Class 3 - Compulsory acquisition of rights - Underground cable system
 - Class 4 - Compulsory acquisition of rights - Overhead line and underground cable system
 - Class 5 - Compulsory acquisition of rights - Access
 - Class 6 - Compulsory acquisition of rights - Drainage
 - Class 7 - Temporary use
 - Class 8 - Land not subject to powers of acquisition nor temporary use

Notes

1. For additional detail on the plan suites, please refer to the Guide to Plans (document reference 2.0), located in the Volume 2 of the DCO application.

2. This drawing is scaled at paper size A0, therefore any prints taken at smaller sizes will affect accuracy of the measurement units and should not be scaled against.

Coordinate System: British National Grid
Sheet X Centroid Coordinate: 579578 Sheet Y Centroid Coordinate: 217745

0 40 80 120 160 200 240 Metres

BACKGROUND MAPPING INFORMATION HAS BEEN REPRODUCED FROM THE ORDNANCE SURVEY BY PERMISSION OF ORDNANCE SURVEY OF THE CONTROLLER OF HIS MAJESTY'S STATIONERY OFFICE. © CROWN COPYRIGHT AND DATABASE RIGHTS(2025) LICENCE OS100024241 AND AC0000807948.

A	Issue	Date	Remarks	Drawn	Checked	Approved
---	-------	------	---------	-------	---------	----------

Title:

THE NATIONAL GRID
(NORWICH TO TILBURY) ORDER
LAND PLANS
REGULATION 5(2)(i)(i)-(iii)
SECTION E (SHEET 5 OF 8
BRAINTREE DISTRICT COUNCIL)

nationalgrid

PINS Application Number EN020027

National Grid Drawing Reference
AENC-TQST-LAN-DWG-0002

Scale 1:2500	Sheet Size A0	Sheet SHEET 5 of 8	Issue A
-----------------	------------------	-----------------------	------------

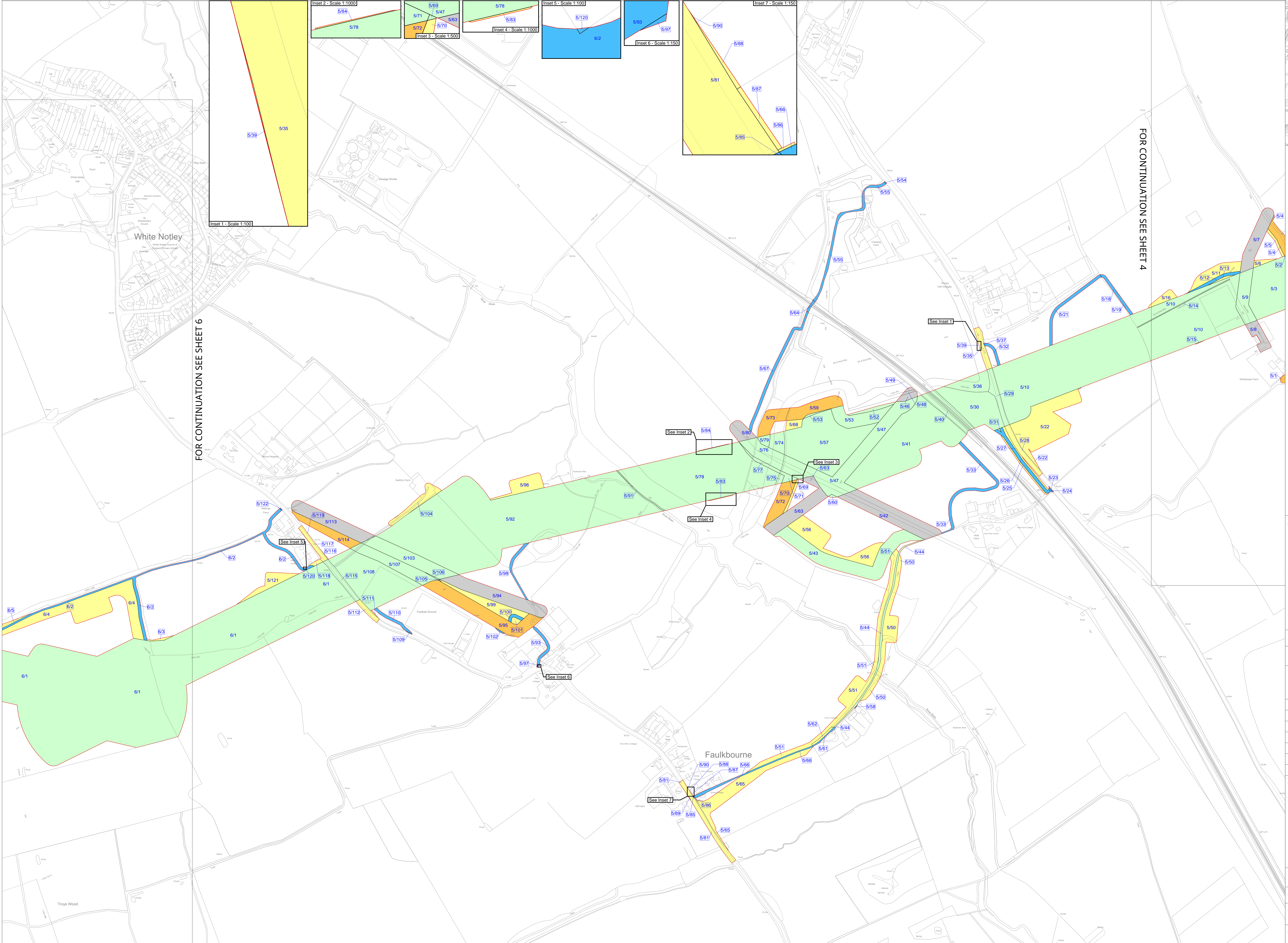

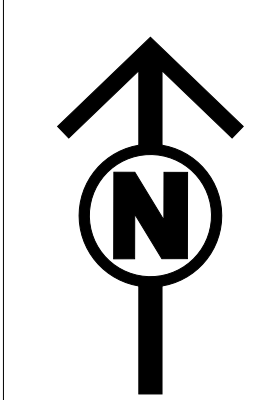

THE NATIONAL GRID (NORWICH TO TILBURY) ORDER
LAND PLANS
REGULATION 5(2)(i)(i)-(iii)
SECTION E (SHEET 6 OF 8,
BRAINTREE DISTRICT COUNCIL)

Application Document 2.2

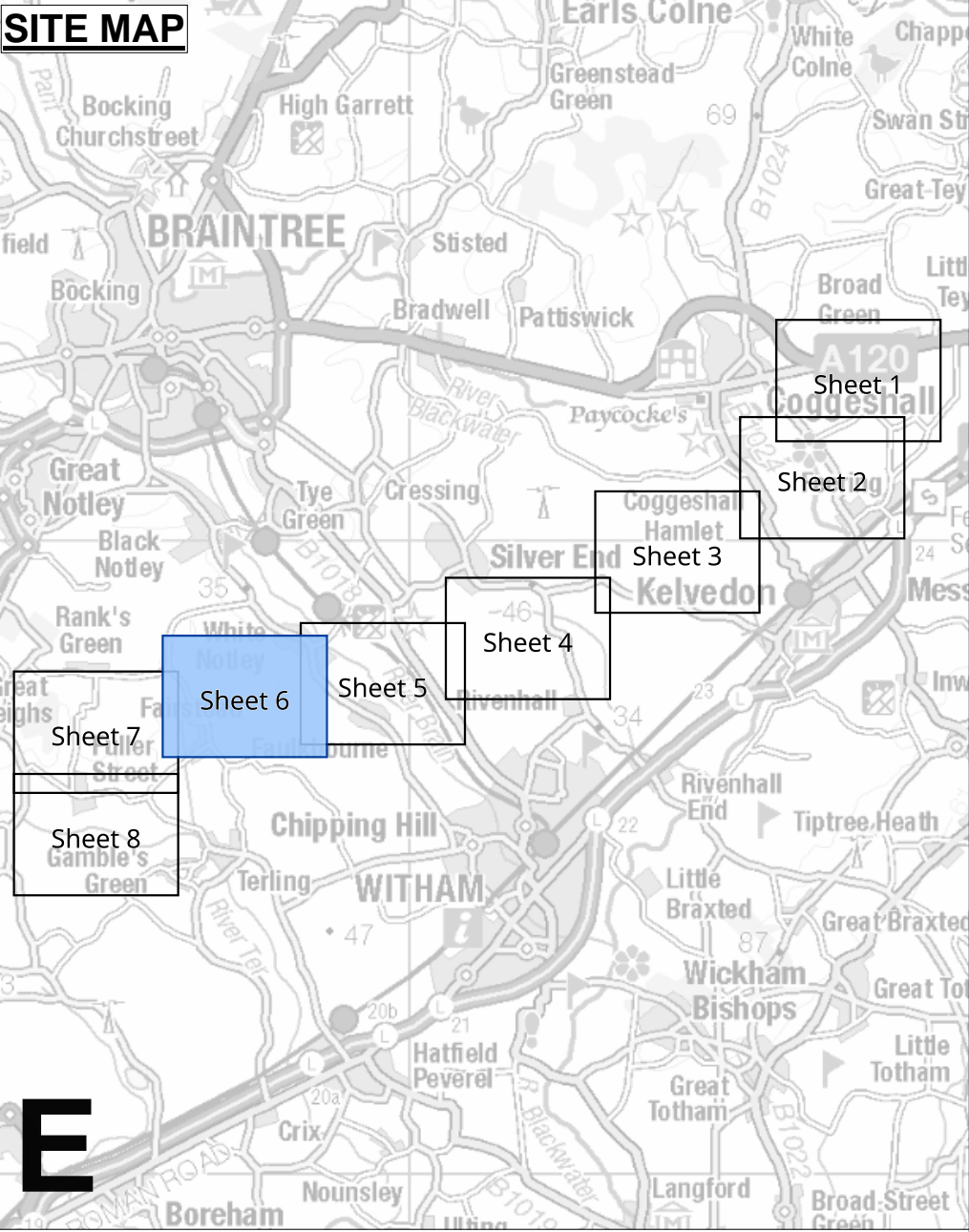

- Legend**
- Local authority boundary
 - Section boundary & local authority boundary
 - Section boundary
 - Sheet index cutlines
 - Order Limits
 - Class 1 - Compulsory acquisition of land
 - Class 2 - Compulsory acquisition of rights - Overhead line
 - Class 3 - Compulsory acquisition of rights - Underground cable system
 - Class 4 - Compulsory acquisition of rights - Overhead line and underground cable system
 - Class 5 - Compulsory acquisition of rights - Access
 - Class 6 - Compulsory acquisition of rights - Drainage
 - Class 7 - Temporary use
 - Class 8 - Land not subject to powers of acquisition nor temporary use

Notes

1. For additional detail on the plan suites, please refer to the Guide to Plans (document reference 2.0), located in the Volume 2 of the DCO application.

2. This drawing is scaled at paper size A0, therefore any prints taken at smaller sizes will affect accuracy of the measurement units and should not be scaled against.

Coordinate System: British National Grid
Sheet X Centroid Coordinate: 577398 Sheet Y Centroid Coordinate: 217546

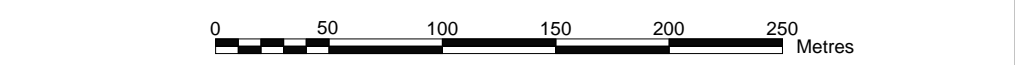

BACKGROUND MAPPING INFORMATION HAS BEEN REPRODUCED FROM THE ORDNANCE SURVEY BY PERMISSION OF ORDNANCE SURVEY OF THE CONTROLLER OF HIS MAJESTY'S STATIONERY OFFICE. © CROWN COPYRIGHT AND DATABASE RIGHTS(2025) LICENCE OS100024241 AND AC0000807948.

Issue	Date	Remarks	Drawn	Checked	Approved
A	AUG-2025	For DCO submission	CBE	KGA	CLJ

Title:

THE NATIONAL GRID
(NORWICH TO TILBURY) ORDER
LAND PLANS
REGULATION 5(2)(i)(i)-(iii)
SECTION E (SHEET 6 OF 8
BRAINTREE DISTRICT COUNCIL)

nationalgrid

PINS Application Number EN020027

National Grid Drawing Reference
AENC-TQST-LAN-DWG-0002

Scale 1:2500	Sheet Size A0	Sheet SHEET 6 of 8	Issue A
------------------------	-------------------------	------------------------------	-------------------

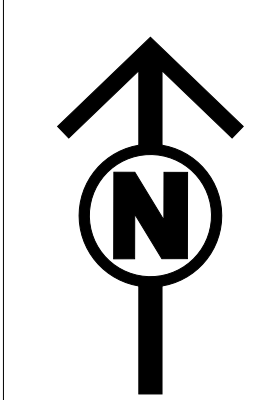

THE NATIONAL GRID (NORWICH TO TILBURY) ORDER
LAND PLANS
REGULATION 5(2)(i)(i)-(iii)
SECTION E (SHEET 7 OF 8,
BRAINTREE DISTRICT COUNCIL AND CHELMSFORD CITY COUNCIL)

Application Document 2.2

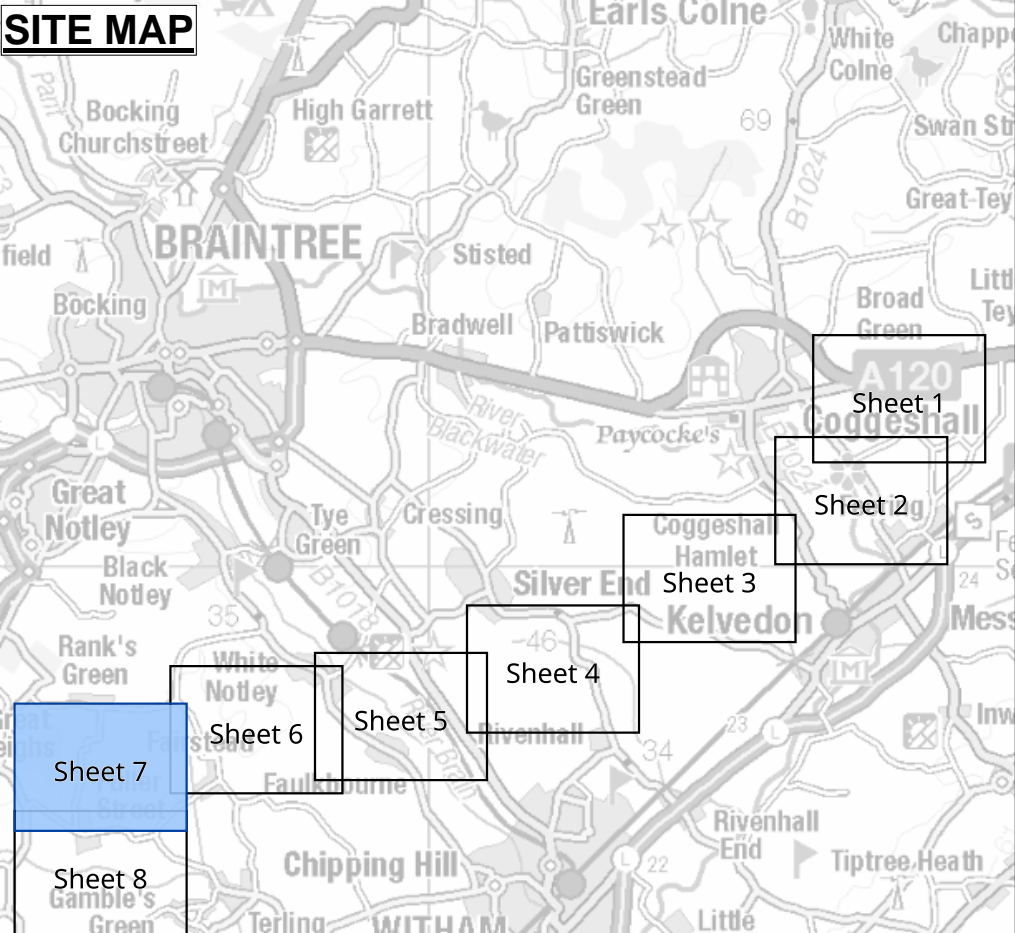

E

- Legend**
- Local authority boundary
 - Section boundary & local authority boundary
 - Section boundary
 - Sheet index cutlines
 - Order Limits
 - Class 1 - Compulsory acquisition of land
 - Class 2 - Compulsory acquisition of rights - Overhead line
 - Class 3 - Compulsory acquisition of rights - Underground cable system
 - Class 4 - Compulsory acquisition of rights - Overhead line and underground cable system
 - Class 5 - Compulsory acquisition of rights - Access
 - Class 6 - Compulsory acquisition of rights - Drainage
 - Class 7 - Temporary use
 - Class 8 - Land not subject to powers of acquisition nor temporary use

Notes

1. For additional detail on the plan suites, please refer to the Guide to Plans (document reference 2.0), located in the Volume 2 of the DCO application.

2. This drawing is scaled at paper size A0, therefore any prints taken at smaller sizes will affect accuracy of the measurement units and should not be scaled against.

Coordinate System: British National Grid
Sheet X Centroid Coordinate: 575048 Sheet Y Centroid Coordinate: 216980

BACKGROUND MAPPING INFORMATION HAS BEEN REPRODUCED FROM THE ORDNANCE SURVEY BY PERMISSION OF ORDNANCE SURVEY OF THE CONTROLLER OF HIS MAJESTY'S STATIONERY OFFICE. © CROWN COPYRIGHT AND DATABASE RIGHTS(2025) LICENCE OS100024241 AND AC0000807948.

Issue	Date	Remarks	Drawn	Checked	Approved
A	AUG-2025	For DCO submission	CBE	KGA	CLJ

Title:

THE NATIONAL GRID
(NORWICH TO TILBURY) ORDER
LAND PLANS
REGULATION 5(2)(i)(i)-(iii)
SECTION E (SHEET 7 OF 8
BRAINTREE DISTRICT COUNCIL
AND CHELMSFORD CITY COUNCIL)

nationalgrid

<u>PINS Application Number</u>		EN020027	
<u>National Grid Drawing Reference</u>			
AENC-TQST-LAN-DWG-0002			
<u>Scale</u>	<u>Sheet Size</u>	<u>Sheet</u>	<u>Issue</u>
1:2500	A0	SHEET 7 of 8	A

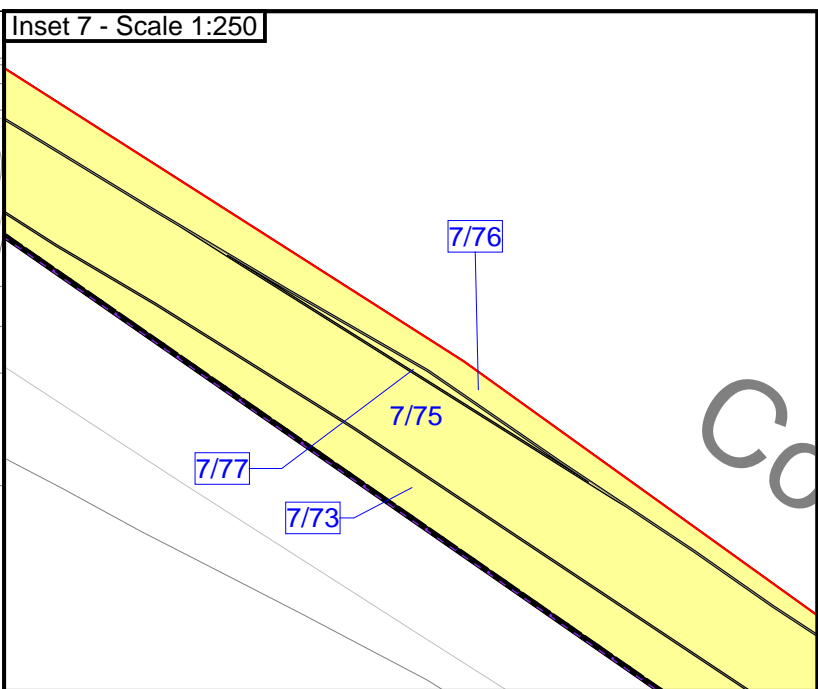
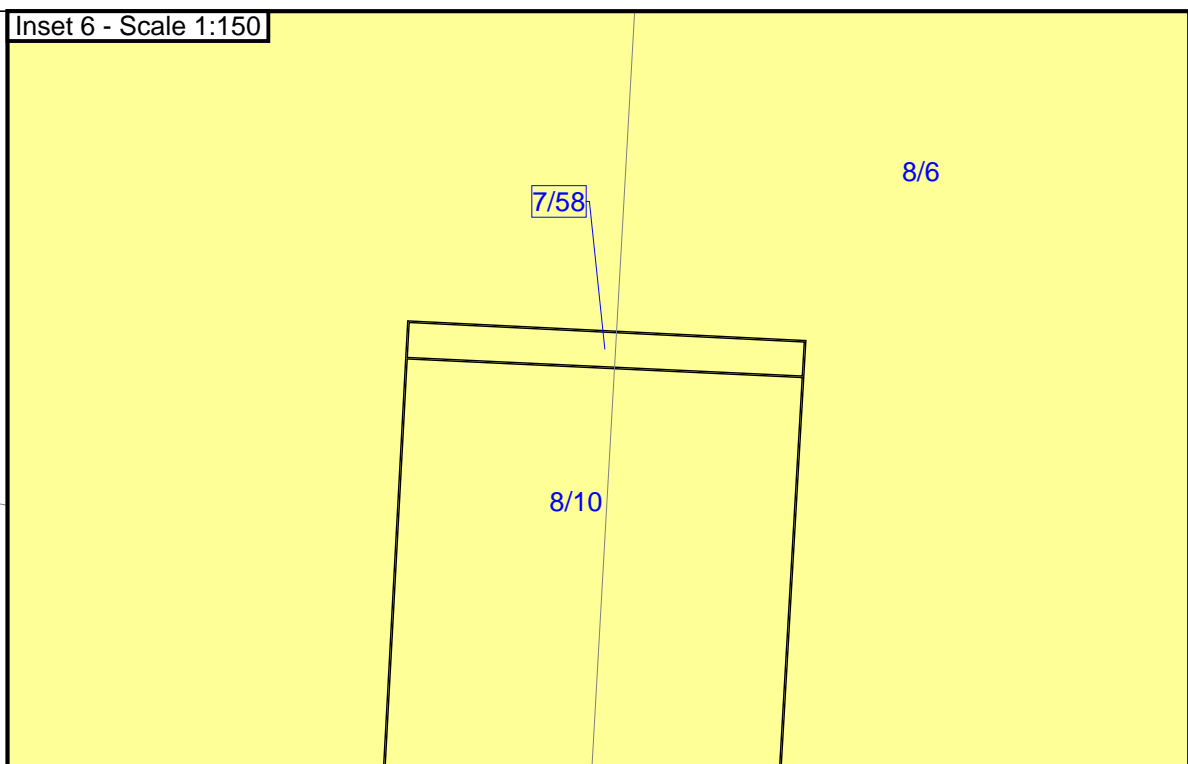
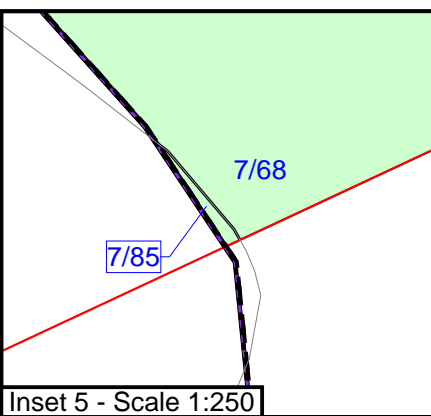
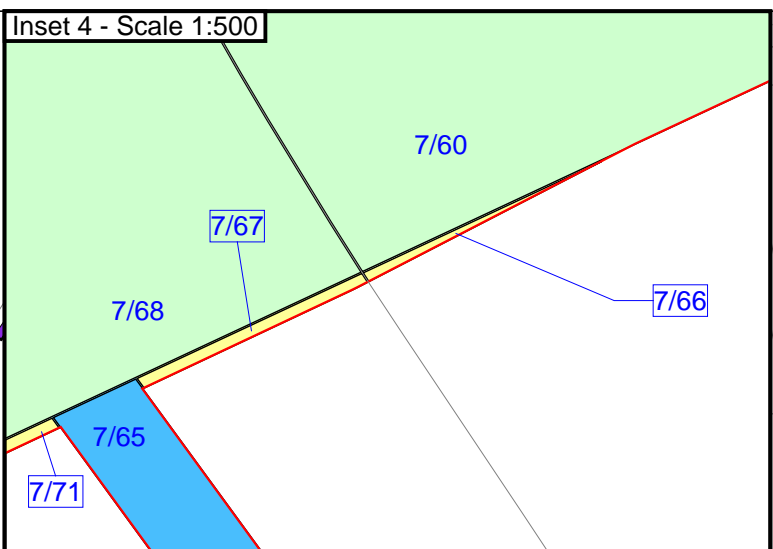
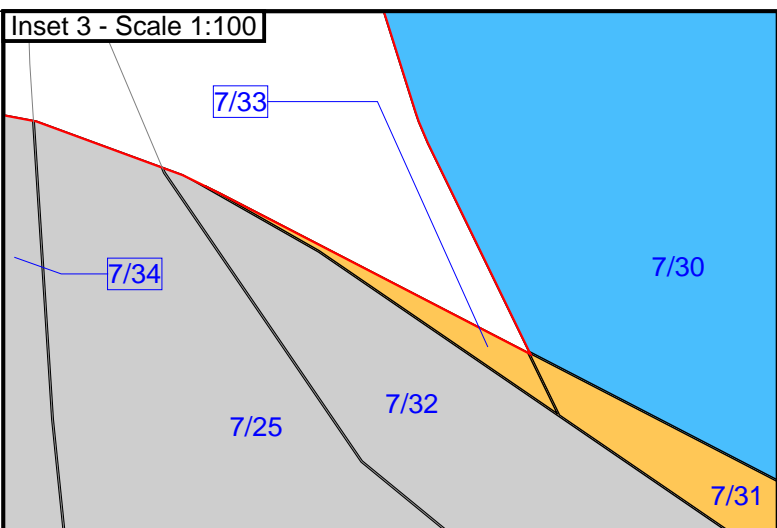
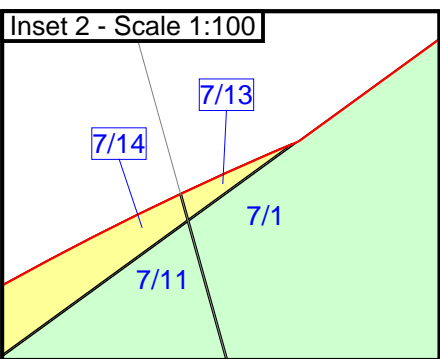
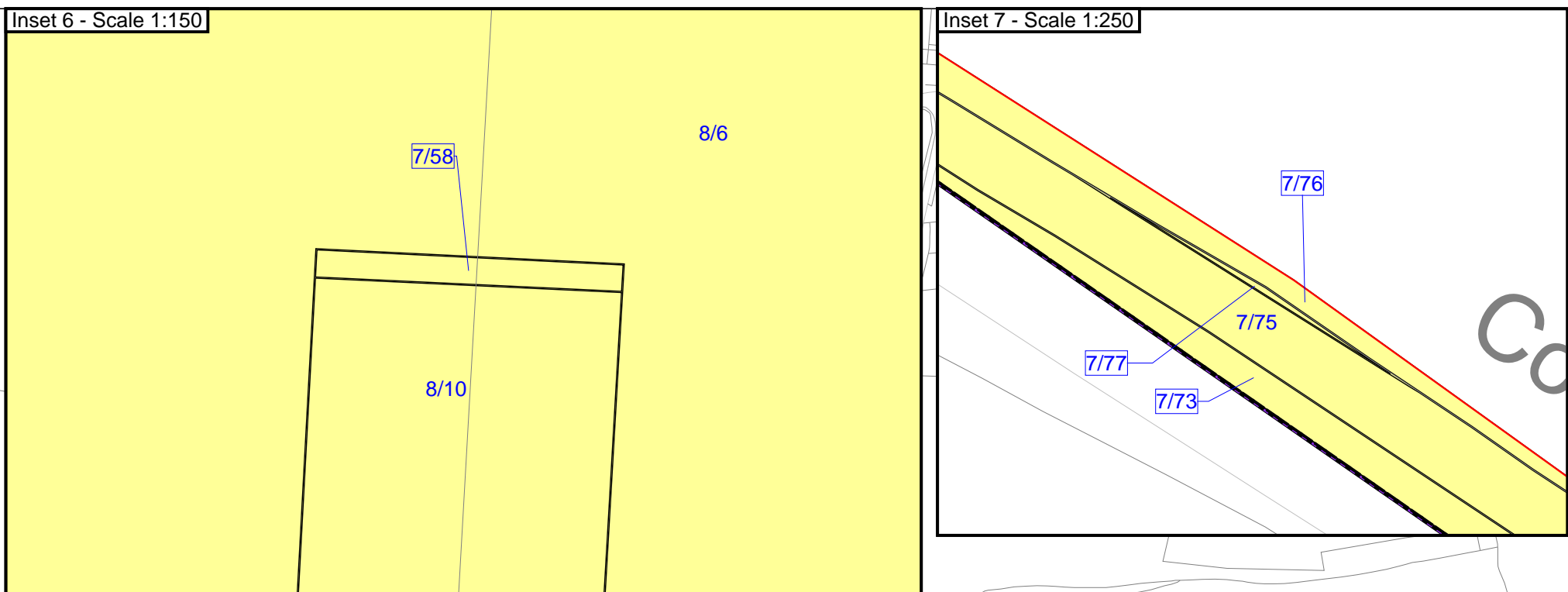
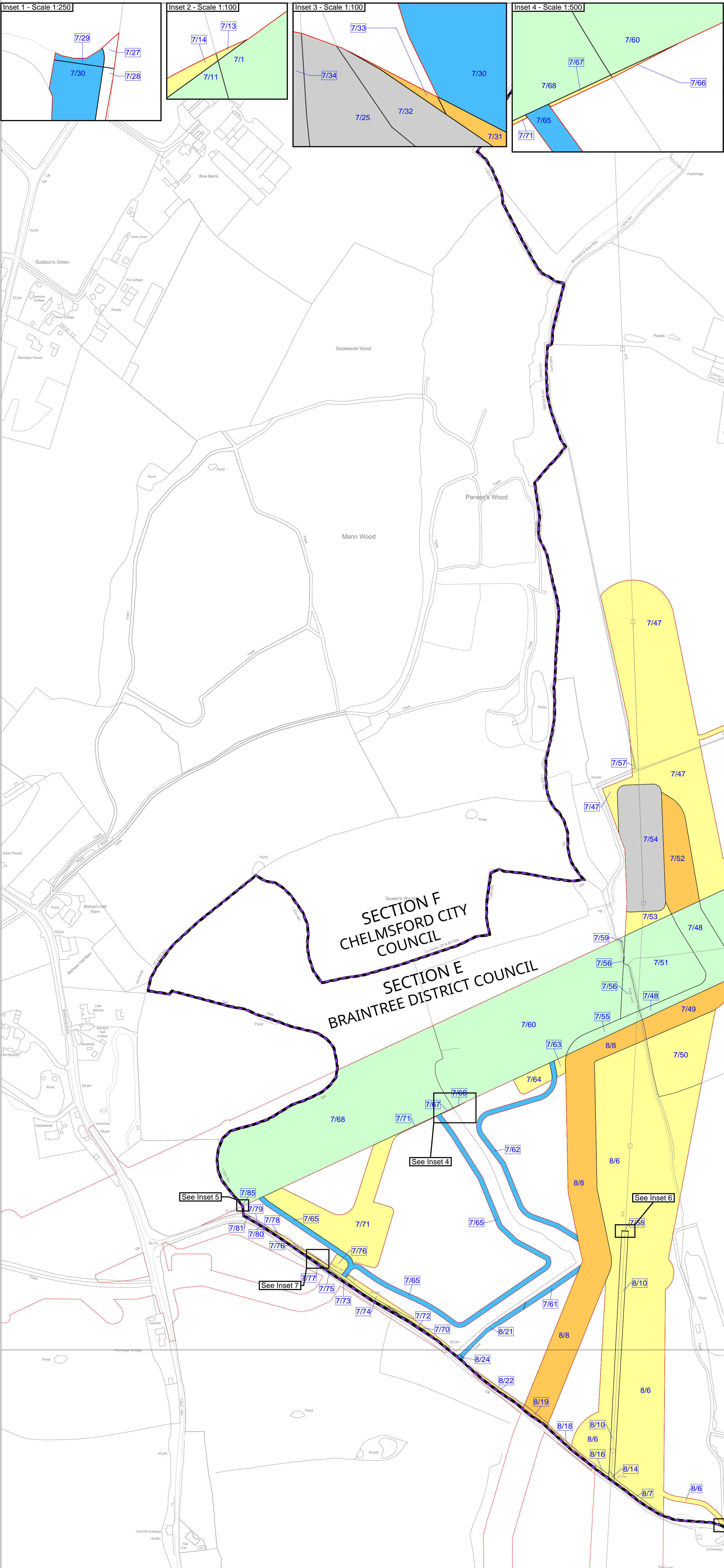

FOR CONTINUATION SEE SHEET 6

FOR CONTINUATION SEE SHEET 8

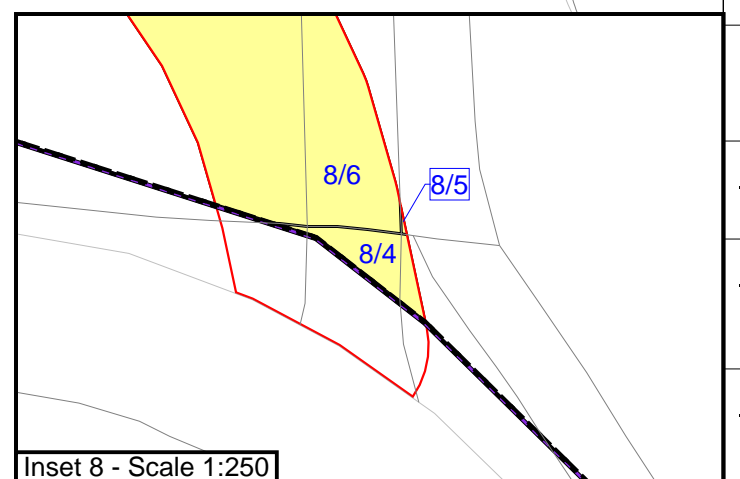

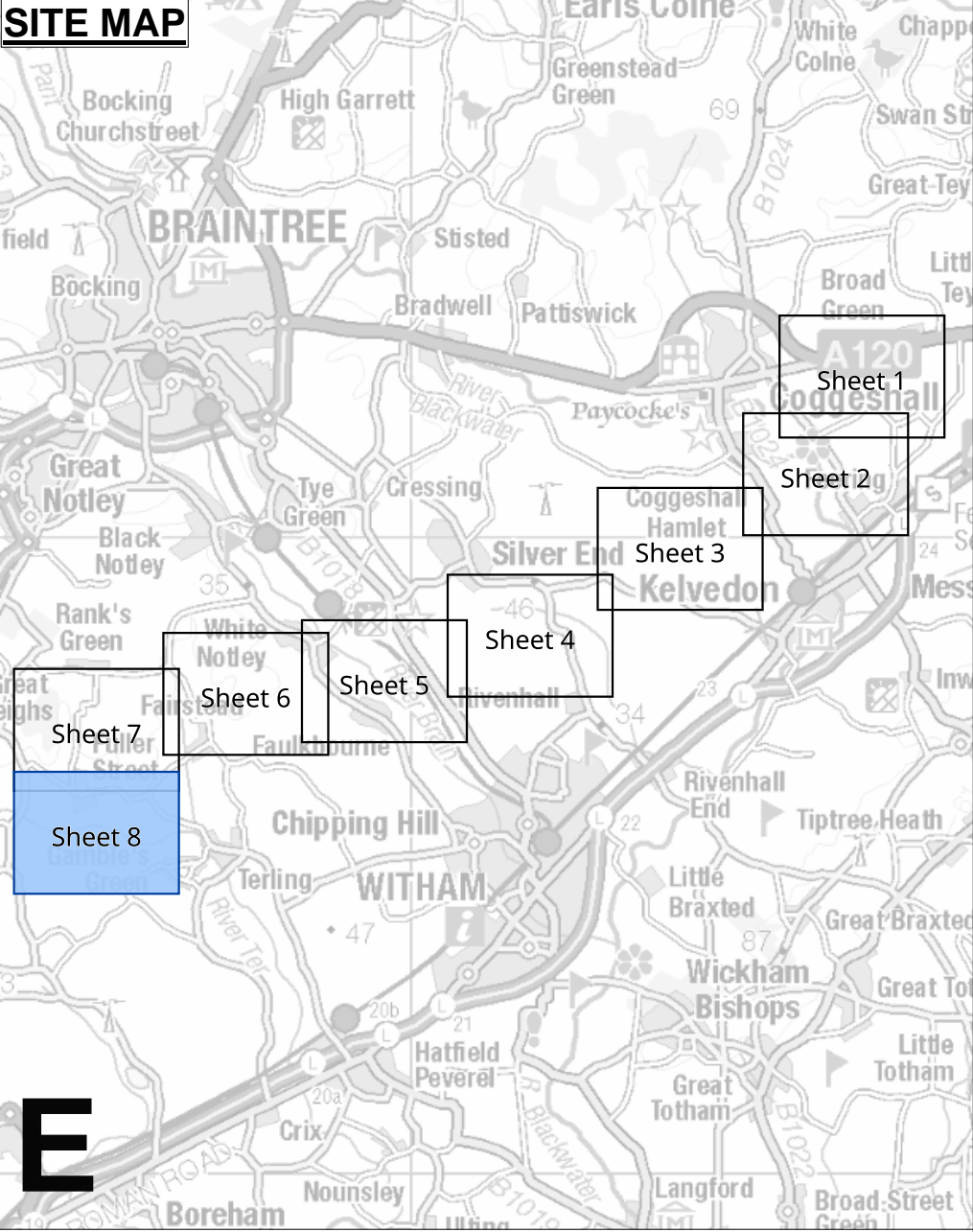
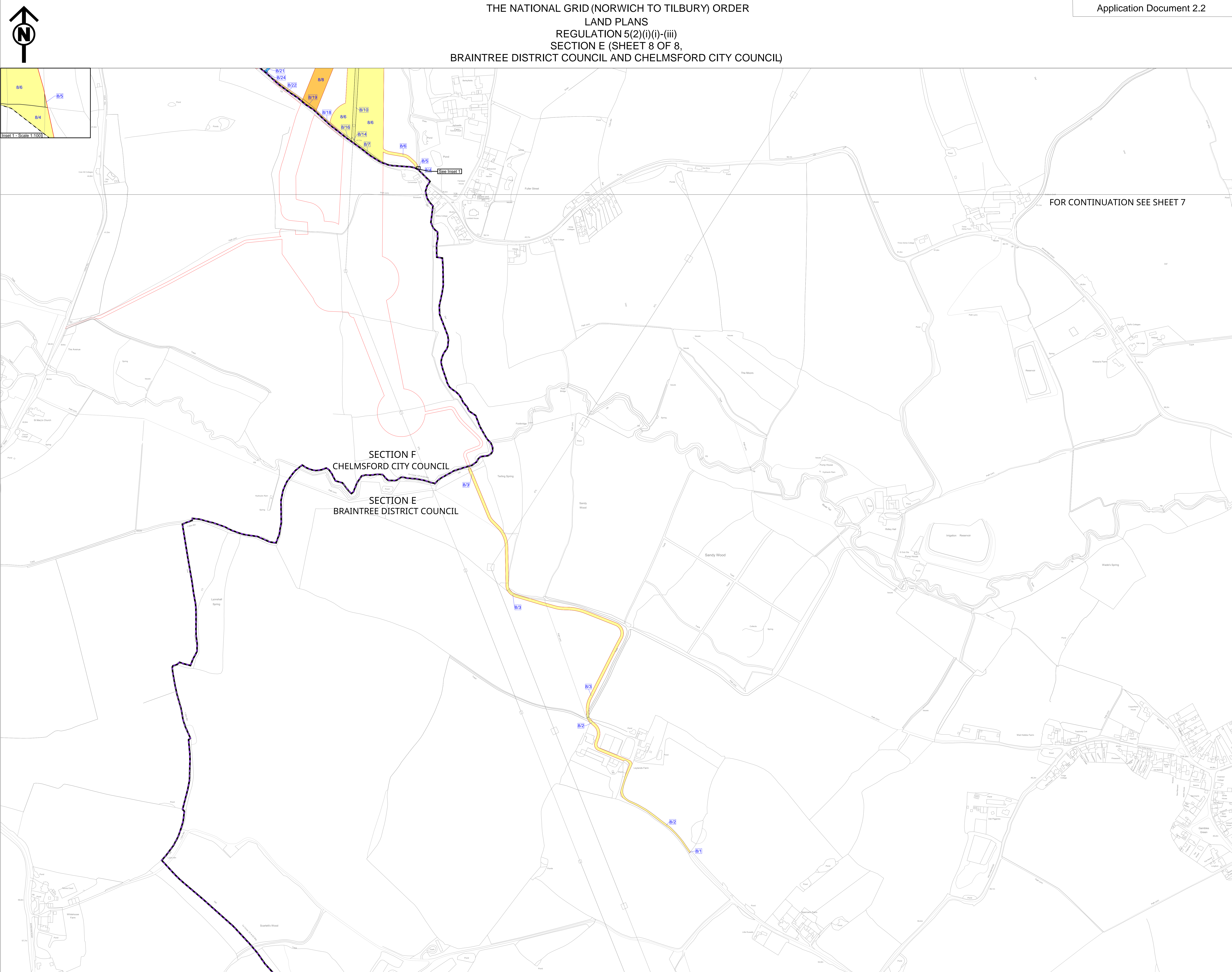

- Legend**
- Local authority boundary
 - Section boundary & local authority boundary
 - Section boundary
 - Sheet index cutlines
 - Order Limits
 - Class 1 - Compulsory acquisition of land
 - Class 2 - Compulsory acquisition of rights - Overhead line
 - Class 3 - Compulsory acquisition of rights - Underground cable system
 - Class 4 - Compulsory acquisition of rights - Overhead line and underground cable system
 - Class 5 - Compulsory acquisition of rights - Access
 - Class 6 - Compulsory acquisition of rights - Drainage
 - Class 7 - Temporary use
 - Class 8 - Land not subject to powers of acquisition nor temporary use

Notes

1. For additional detail on the plan suites, please refer to the Guide to Plans (document reference 2.0), located in the Volume 2 of the DCO application.

2. This drawing is scaled at paper size A0, therefore any prints taken at smaller sizes will affect accuracy of the measurement units and should not be scaled against.

Coordinate System: British National Grid
Sheet X Centroid Coordinate: 575048 Sheet Y Centroid Coordinate: 215361

0 40 80 120 160 200 240 Metres

BACKGROUND MAPPING INFORMATION HAS BEEN REPRODUCED FROM THE ORDNANCE SURVEY BY PERMISSION OF ORDNANCE SURVEY OF THE CONTROLLER OF HIS MAJESTY'S STATIONERY OFFICE. © CROWN COPYRIGHT AND DATABASE RIGHTS(2025) LICENCE OS100024241 AND AC0000807948.

Issue	Date	Remarks	Drawn	Checked	Approved
A	AUG-2025	For DCO submission	CBE	KGA	CLJ

Title:

THE NATIONAL GRID
(NORWICH TO TILBURY) ORDER
LAND PLANS
REGULATION 5(2)(i)(i)-(iii)
SECTION E (SHEET 8 OF 8
BRAINTREE DISTRICT COUNCIL
AND CHELMSFORD CITY COUNCIL)

nationalgrid			
<u>PINS Application Number</u>		EN020027	
<u>National Grid Drawing Reference</u>			
AENC-TQST-LAN-DWG-0002			
<u>Scale</u>	<u>Sheet Size</u>	<u>Sheet</u>	<u>Issue</u>
1:2500	A0	SHEET 8 of 8	A